

## L-Based Foot Adjustable 8

To fix aluminum profiles to the floor vertically adjustable; with adjustment screw and threaded plate. Lifting height 72 mm.

Assembly set includes 1 T-slot nut - Nut 8 - M8, 1 screw ISO 7380 - M8 × 16.

**Material:** Zinc die-cast. Assembly set in steel.

**System:** 40 - Slot 8

**Type:** Feet

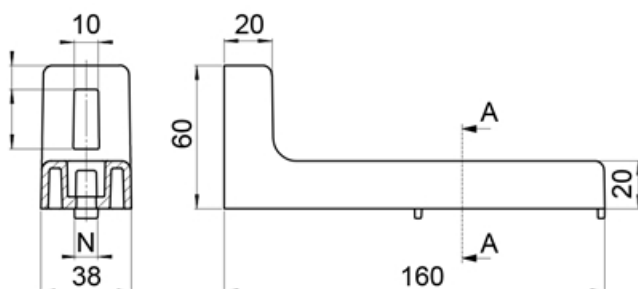

## General Data

Designation	Description	System	Weight (g)
PZ1296	L-Based Foot Adjustable 8	40 - Slot 8	535