

## WB

Dimensions in mm. Other tolerances according to standard shaft W.

Length tolerance:  $\pm 3$  mm, separating cut deburred.  
Distance tolerance  $\pm 0,2$ mm, P1 = P2  
Positional tolerance of thread  $\varnothing$  ( $\pm 0,2$  mm).

Thread depth = A  
Thread dimension = C and S.

Other pitch available on request.

Contact us for CAD-files.

**Material:** Quenched and tempered steel Cf53 / 1.1213 / C53G

**Surface hardness:** 59 HRC min.

**Standard Tolerance:** ISO h6



## Dimensions

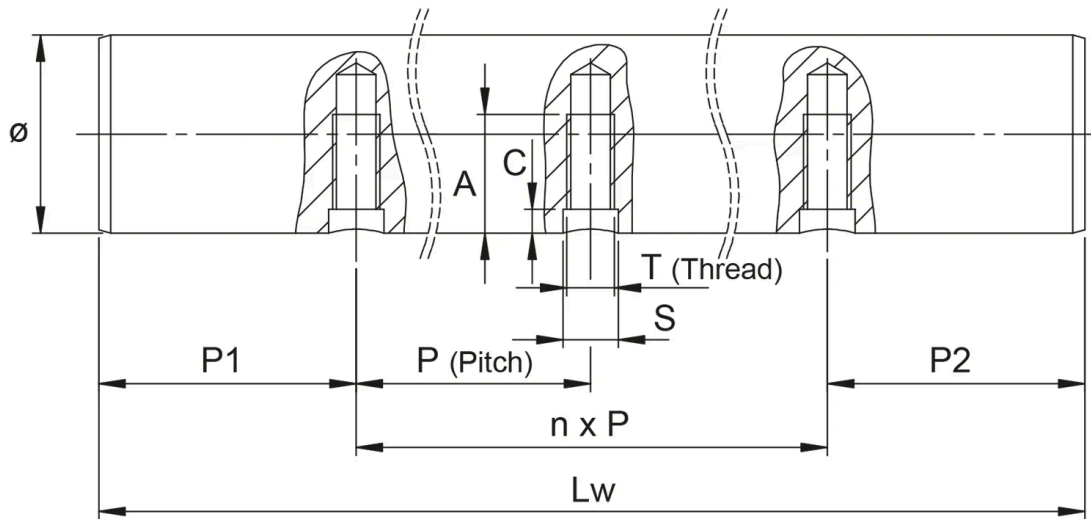

Designation	S	A	C	T	P1	P	Lw (mm)	Diameter
<b>WB12</b>	5	7	2	M4	37.5	75	6000	12
<b>WB16</b>	6	9	2.5	M5	50	100	6000	16
<b>WB20</b>	7	11	3	M6	50	100	6000	20
<b>WB25</b>	9	15	3	M8	60	120	6000	25
<b>WB30</b>	11	17	3.5	M10	75	150	6000	30
<b>WB40</b>	11	19	4	M10	100	200	6000	40