

LME....UUOP

Dimensions in mm.
Other types available on request.

Material: 100Cr6



General Data

Designation	Dynamic Load Capacity (N)	Static Load Capacity (N)	Number Of Ball Rows
LME12UUOP	520	790	3
LME16UUOP	590	910	4
LME20UUOP	880	1400	4
LME25UUOP	1000	1600	5
LME30UUOP	1600	2800	5
LME40UUOP	2200	4000	5
LME50UUOP	3900	8100	5

Dimensions

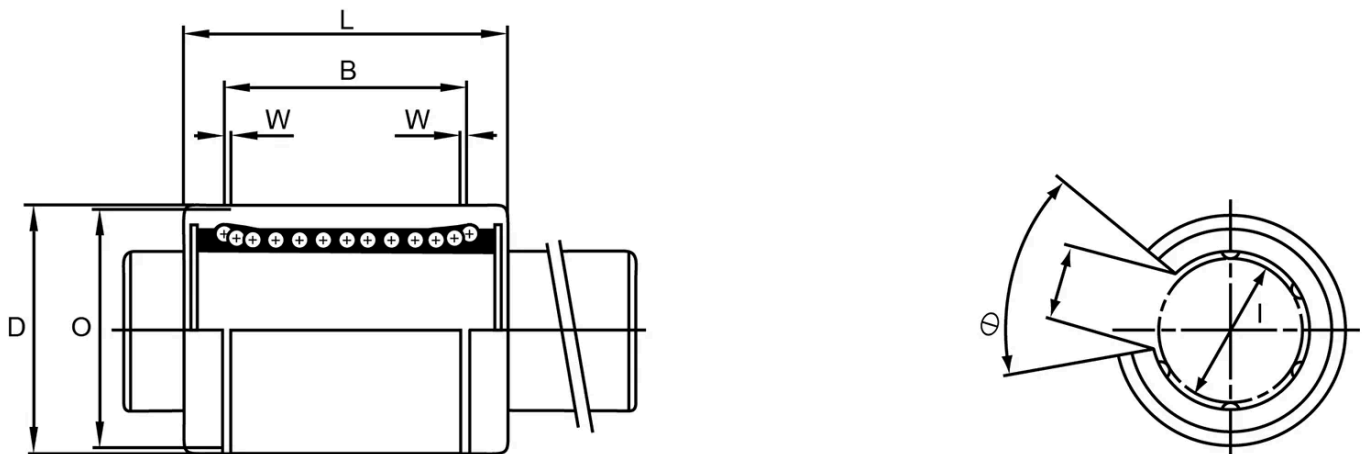

Designation	I	D	L	W	B	O	θ
LME12UUOP	12	22	32	1.3	22.9	21	78°
LME16UUOP	16	26	36	1.3	24.9	24.9	78°
LME20UUOP	20	32	45	1.6	31.5	30.3	60°
LME25UUOP	25	40	58	1.85	44.1	37.5	60°
LME30UUOP	30	47	68	1.85	52.1	44.5	60°
LME40UUOP	40	62	80	2.15	60.6	59	60°
LME50UUOP	50	75	100	2.65	77.6	72	60°